



## WESTFORK 850 MAXHAM ROAD - 123,481 SF

850 Maxham Road  
Lithia Springs, Georgia 30122



### OVERVIEW

Located at Westfork, this listing features 123,481 square feet of available space. Strategically positioned in pro-business East Douglas County, the property is adjacent to I-20 on Thornton Road and is just 15 minutes from downtown Atlanta and Hartsfield International Airport.

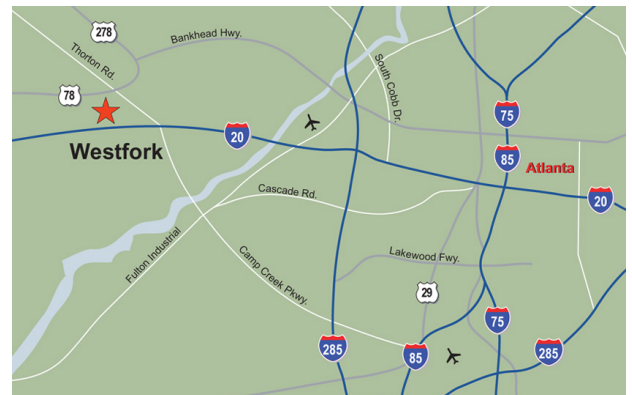

### SPECIFICATIONS

Total Building SF:	292,281
Available Building SF:	123,481
Contiguous Range:	123,481 - 123,481 SF
Office SF:	3,468
Clear Height:	30'
Column Spacing:	50' x 42'
Dock(s):	19/ 1 DI
Fire Sprinkler:	ESFR/ 75 PSI
Power:	277/480 Volt, 3 Phase
Slab Thickness:	7'
Truck Court:	130'
Parking:	85 Spaces
Year Built:	1999
Date Available:	Now

### CONTACT

**Robert M. Tardy**  
IDI Corporate Headquarters Office  
1100 Peachtree Street  
Suite 1100  
Atlanta, Georgia 30309  
404.479.4087  
btardy@idi.com

**WESTFORK**  
**850 MAXHAM ROAD - 123,481 SF**

850 Maxham Road  
Lithia Springs, Georgia 30122

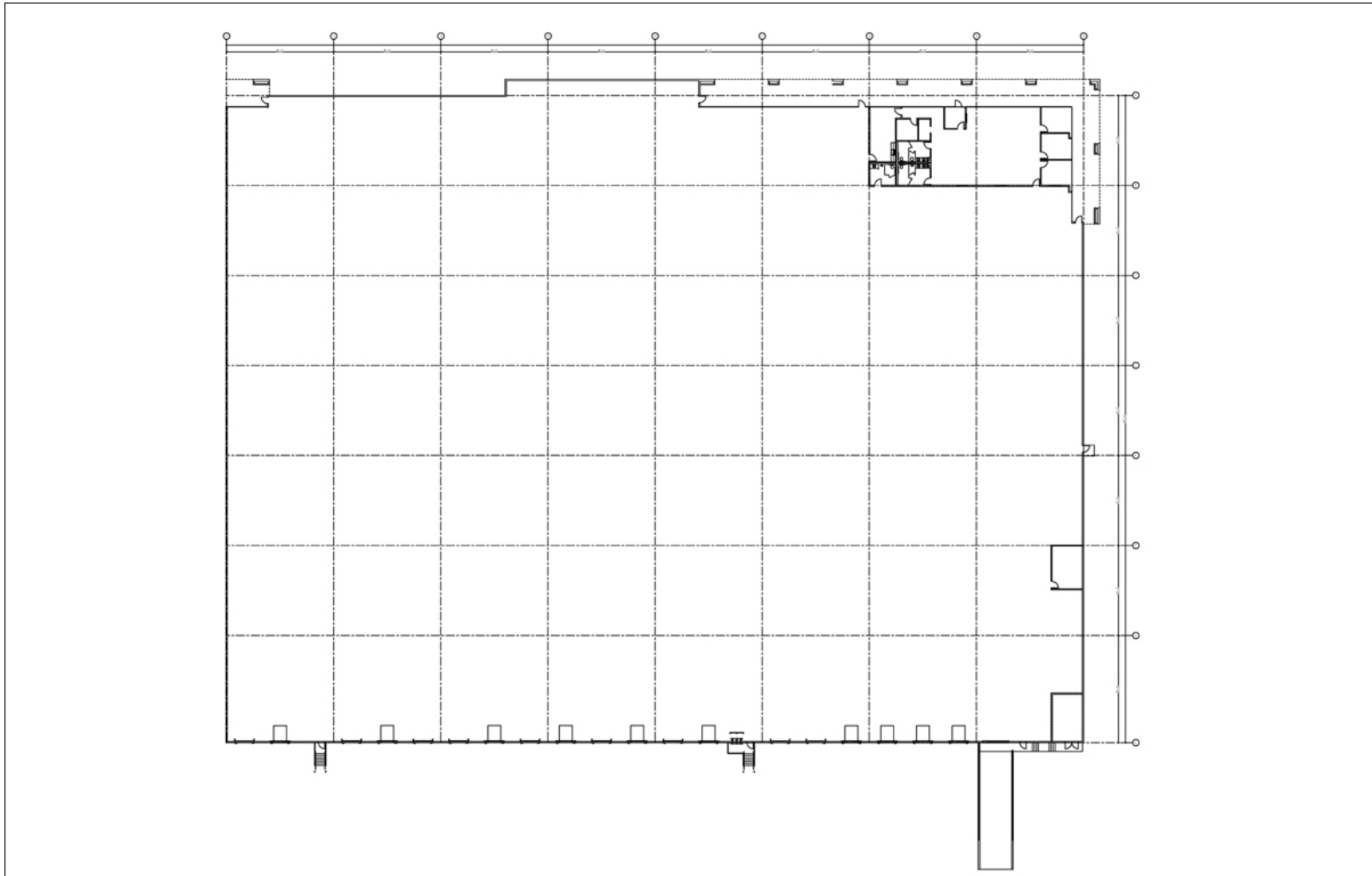

© 2011 Industrial Developments International, Inc. All rights reserved. All trademarks are the property of their respective companies. While we have no reason to doubt the accuracy of the information provided here from sources we deem reliable, we regret we cannot guarantee it. All information should be verified by the recipient prior to lease, purchase exchange, or execution of legal documents. We assume no liability for errors, omissions or changes to this content.



Robert M. Tardy 404.479.4087