



PARK MIRA LOMA SOUTH BUILDING B NORTH - TO SUIT

11296 Harrel Street
Mira Loma, California 91752



OVERVIEW

B North is Phase IV of the Park Mira Loma South Development. The state-of-the-art planned distribution facility offers easy freeway access and Foreign-Trade Zone status.

- 353,742-SF Site Available for Build-to-Suit
- Convenient Access to Three Major Freeways (I-15, I-10 and 60)
- 90 Minutes to Ports of Long Beach/Los Angeles
- 90 Minutes to LAX Airport
- One Day's Drive to Vegas, Phoenix and Denver Markets
- Competitive Taxes
- High-Tech Labor Pool

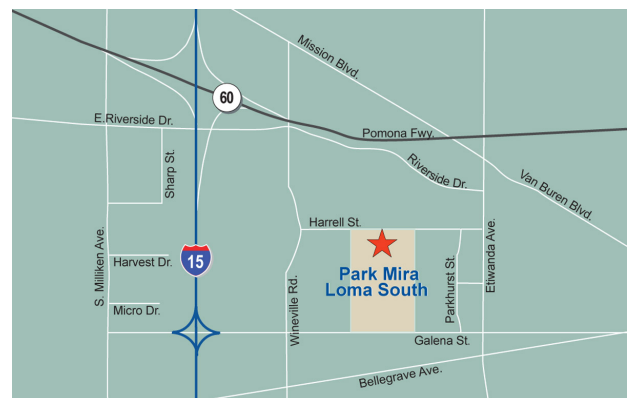

CONTACT

Alan Sharp
IDI Los Angeles Office
26632 Towne Centre Drive
Suite 320
Foothill Ranch, California 92610
949.614.8201
asharp@idi.com

**PARK MIRA LOMA SOUTH
BUILDING B NORTH - TO SUIT**

11296 Harrel Street
Mira Loma, California 91752

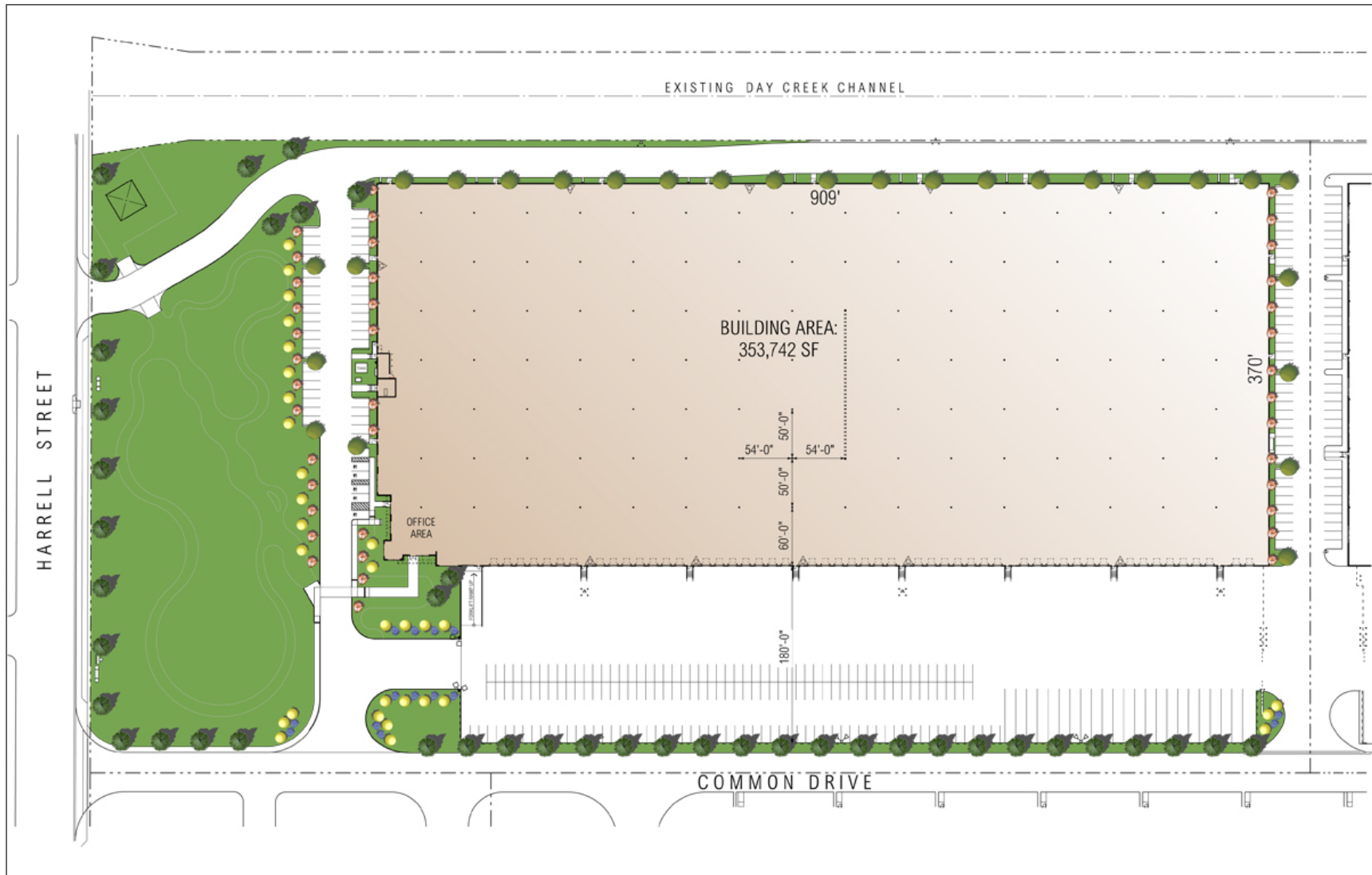

© 2011 Industrial Developments International, Inc. All rights reserved. All trademarks are the property of their respective companies. While we have no reason to doubt the accuracy of the information provided here from sources we deem reliable, we regret we cannot guarantee it. All information should be verified by the recipient prior to lease, purchase exchange, or execution of legal documents. We assume no liability for errors, omissions or changes to this content.



Alan Sharp 949.614.8201