



FIRST COMMERCE WAY BUSINESS PARK BUILDING H

1400 Commerce Way
Woodstock, Ontario N2N 3R6



OVERVIEW

Premier location in Woodstock and in close proximity to new Toyota Manufacturing Plant. This property provides excellent access to Highways 401 and 403.

SPECIFICATIONS

Total Building SF:	333,945
Available Building SF:	333,945
Clear Height:	30'
Column Spacing:	37' x 39'
Contiguous Range:	80,000 - 333,945 SF
Dock Package:	Rear load
Dock(s):	41
Trailer Parking:	Expandable
Drive-in Doors:	4
Fire Sprinkler:	ESFR
Lot Size:	16.88 acres
Office SF:	To Suit
Slab Thickness:	8'
Truck Court:	65'
Parking:	183



CONTACT

Jeff Smith
IDI Chicago Office
500 Park Boulevard
Suite 750
Itasca, Illinois 60143
630.919.1045
jsmith@idi.com

FIRST COMMERCE WAY BUSINESS PARK BUILDING H

1400 Commerce Way
Woodstock, Ontario N2N 3R6

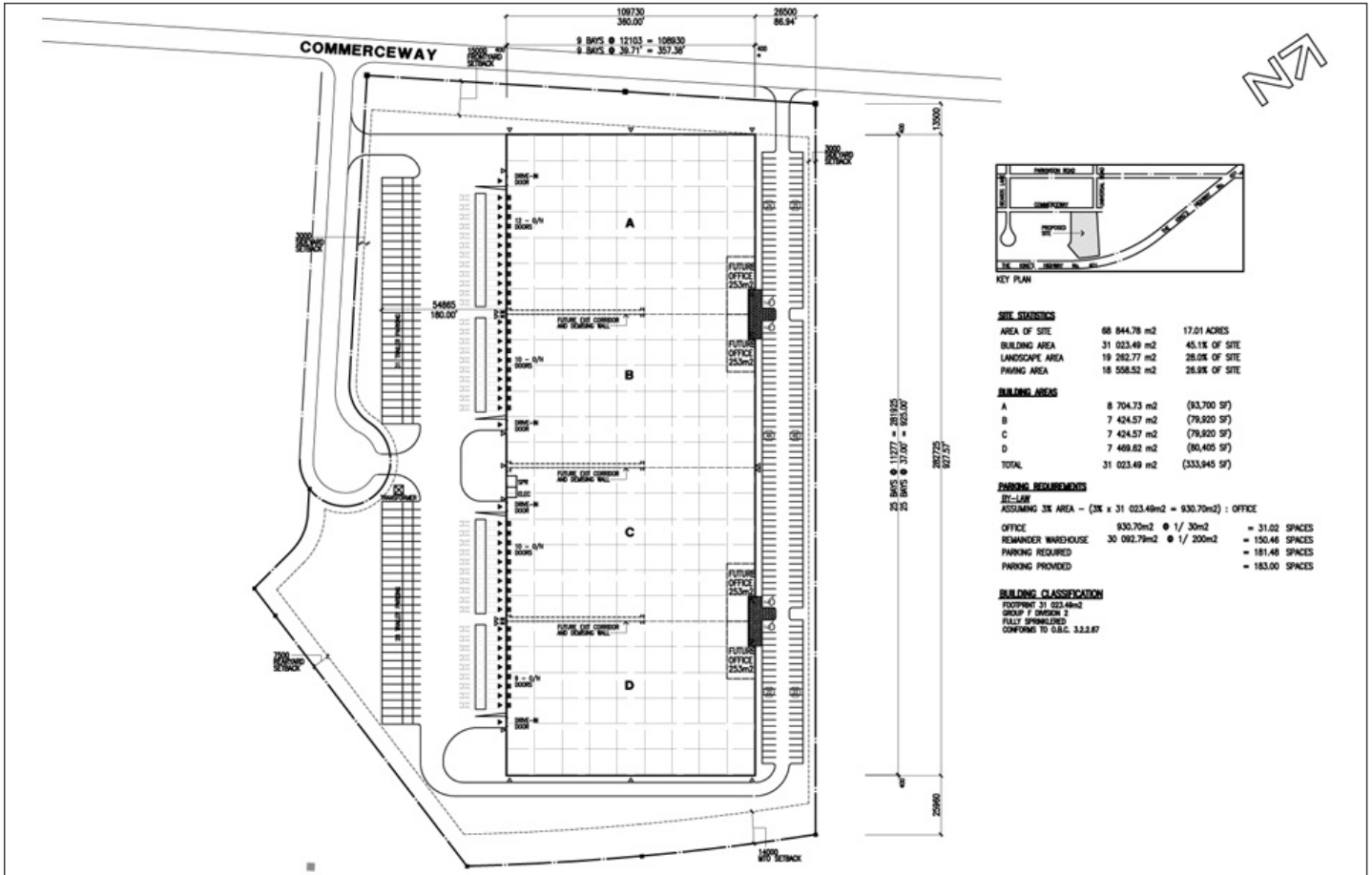

DIRECTIONS

First Commerce Way Business Park in Woodstock, Ontario with frontage on Highway 401 west of the convergence of Highways 401 and 403.



Jeff Smith 630.919.1045



Ron Jansen 519-570-1330 ext 7006
 Mark Sevenpifer 416.626.1700
 Ext. 2828

© 2011 Industrial Developments International, Inc. All rights reserved. All trademarks are the property of their respective companies. While we have no reason to doubt the accuracy of the information provided here, from sources we deem reliable, we regret we cannot guarantee it. All information should be verified by the recipient prior to lease, purchase exchange, or execution of legal documents. We assume no liability for errors, omissions or changes to this content.