



CROSS POINTE CORPORATE CENTER 880 ROHLWING ROAD - WAREHOUSE

880 South Rohlwing Road
Addison, Illinois 60101



OVERVIEW

- Low DuPage County taxes included in Base Rent
- Strategic central location at I-355 / North Ave. interchange
- Excellent building identity and/or I-355 signage opportunity for larger users
- Extensive area amenities
- Extremely energy efficient construction with very low overall operating costs with flexible floor plan layouts and lease terms

SPECIFICATIONS

Total Building SF:	145,119
Available Building SF:	101,573
Lot Size:	18.451 Acres
Clear Height:	32'
Date Available:	Immediately
Dock(s):	10
Roof System:	Solarcrete System R-40
Wall Construction:	Solarcrete System R-35
Year Built:	1999
Fire Sprinkler:	Fully Sprinkled - High-density Wet System
Zoning:	M4 Office / Research / Industrial

Parking:

Up to 360 vehicles



CONTACT

Jeff Lanaghan
IDI Chicago Office
500 Park Boulevard
Suite 750
Itasca, Illinois 60143
630.919.1042
jlanaghan@idi.com

**CROSS POINTE CORPORATE CENTER
880 ROHLWING ROAD - WAREHOUSE**

880 South Rohlwing Road
Addison, Illinois 60101

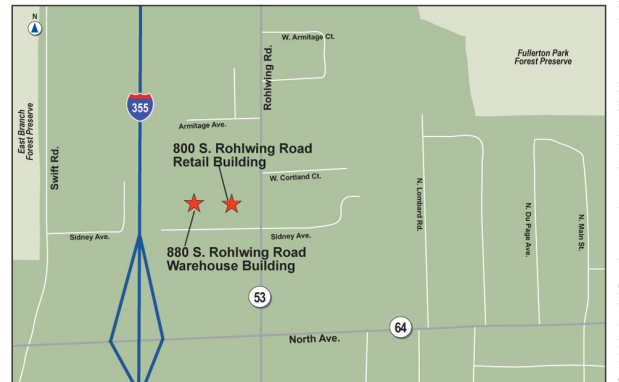
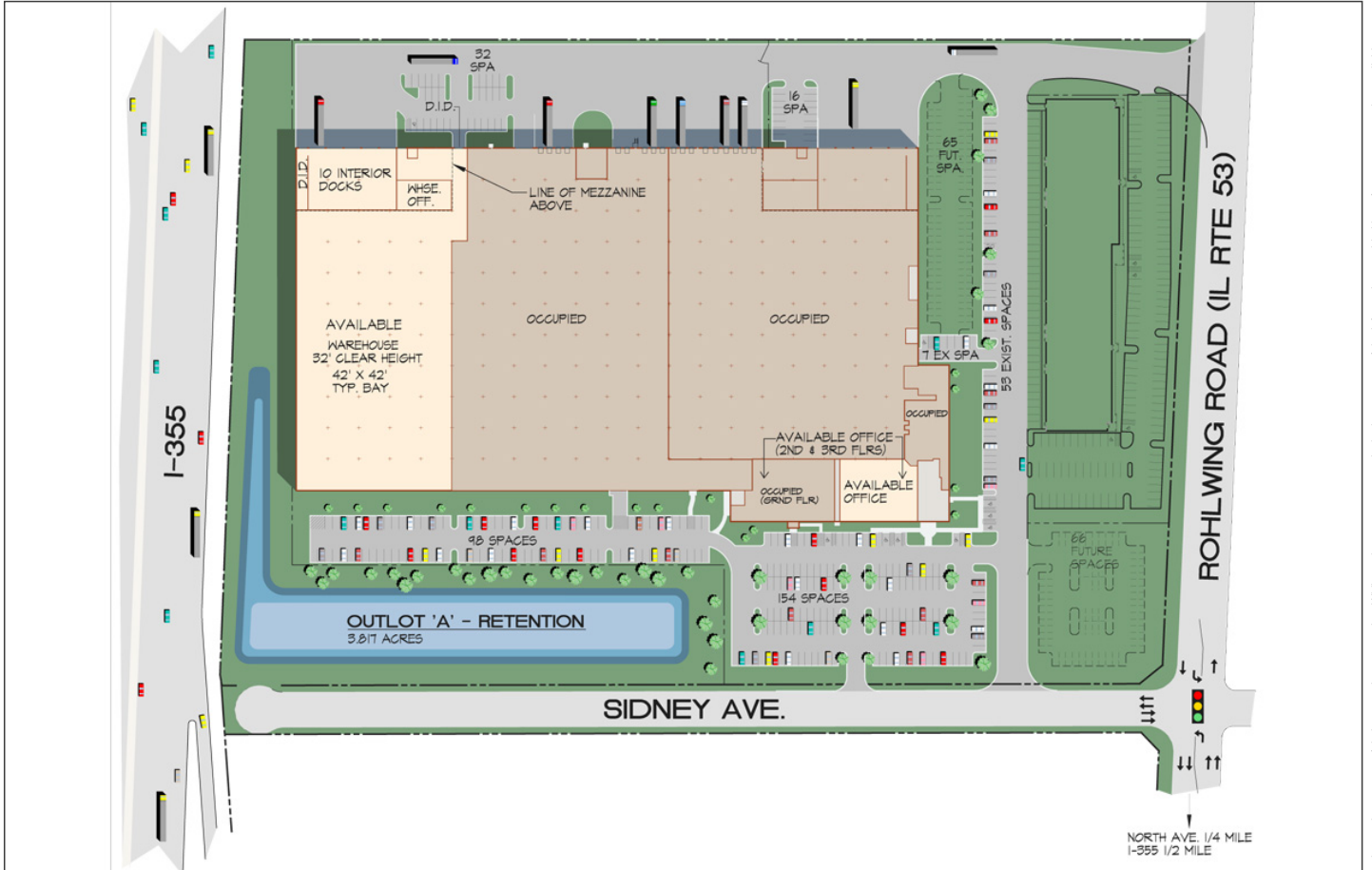

DIRECTIONS

Take Route 83 in Addison, Illinois. Enter Rohlwing Road via North Avenue and I-355

© 2011 Industrial Developments International, Inc. All rights reserved. All trademarks are the property of their respective companies. While we have no reason to doubt the accuracy of the information provided here, from sources we deem reliable, we regret we cannot guarantee it. All information should be verified by the recipient prior to lease, purchase exchange, or execution of legal documents. We assume no liability for errors, omissions or changes to this content.



Jeff Lanaghan 630.919.1042



Commercial Real Estate Services, Worldwide.
Davis Haigh 630.693.0649
John Cash 630.691.0609